





A software-centric platform that accelerates the development and increases the productivity of test, measurement, and control systems.

Improve Measurement Accuracy in Your Application

Jose Miguel Pena

Senior Product Manager, Calibration Services

Why Characterize a Measurement System?

- Inadequate uncertainty
- More accurate system not available
- Difficult to deploy or operate

Solution

- Characterization of calibration system:
 - Using more accurate standards
 - Improved measurement method
- Characterization provides the system:
 - Traceability to SI units
 - Better Measurement Uncertainty
 - Nominal value corrected to a more accurate value

Why it Works

- Individual instruments perform better than the published specifications
- Systems are used in environmental conditions that vary much less than the normal instrument operating ranges
-
- Time related Performance drift is minimized
- System external calibration uncertainty and traceability errors become negligible
- Range errors are removed by characterization of all points of interest
- Relies on short term stability of the system

Warranted Specification

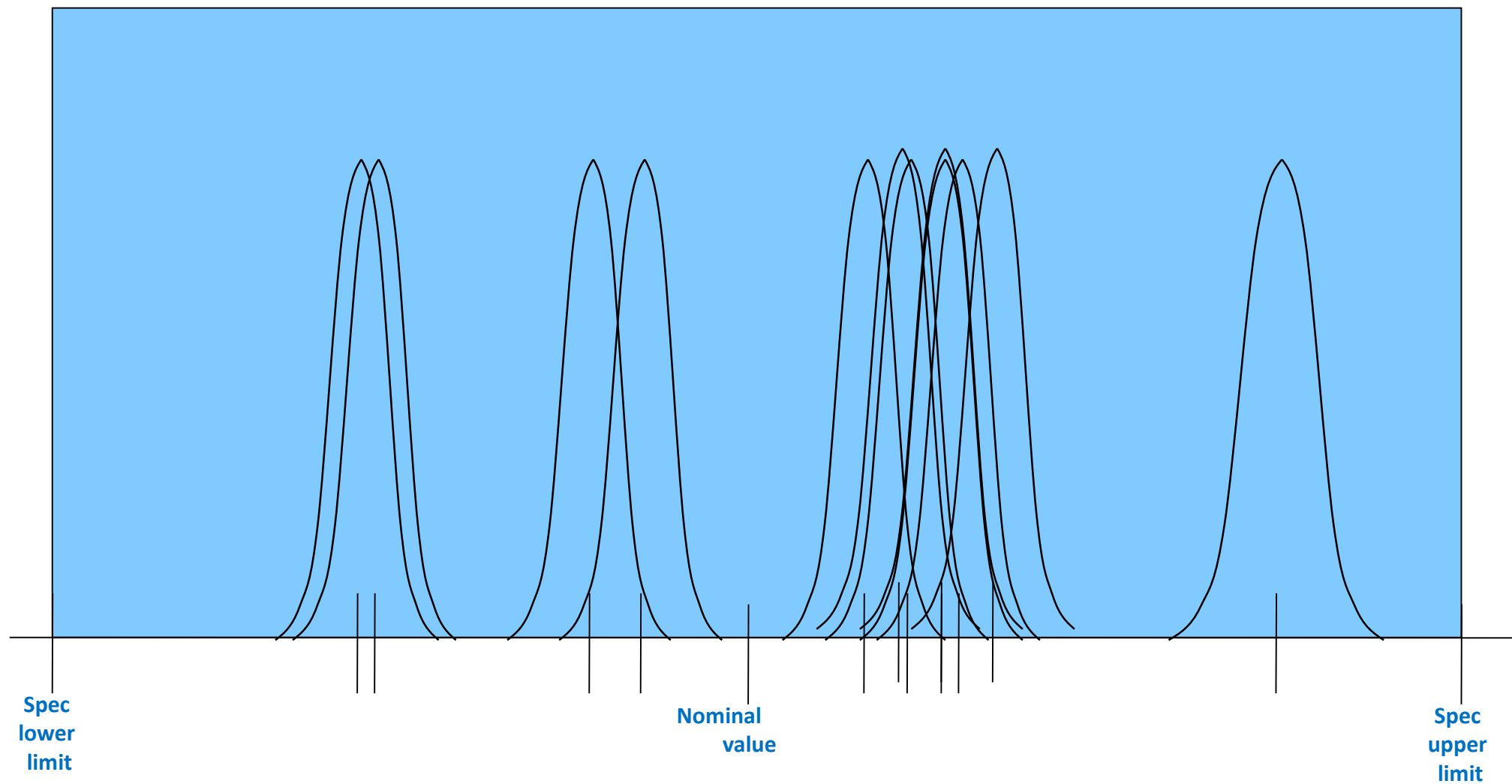

How it Works

Nominal Value	Mfg. Specification	Characterized Value	Characterization Uncertainty
1.000 V	± 10 mV	1.008 V	± 1 mV

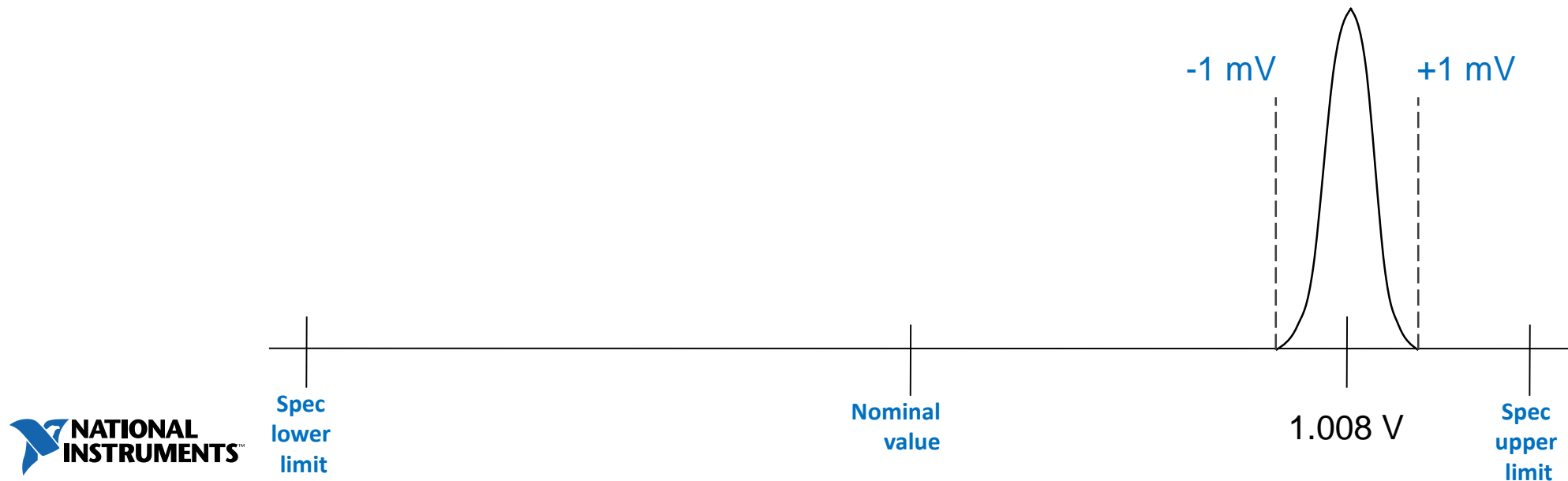

Types of Characterization

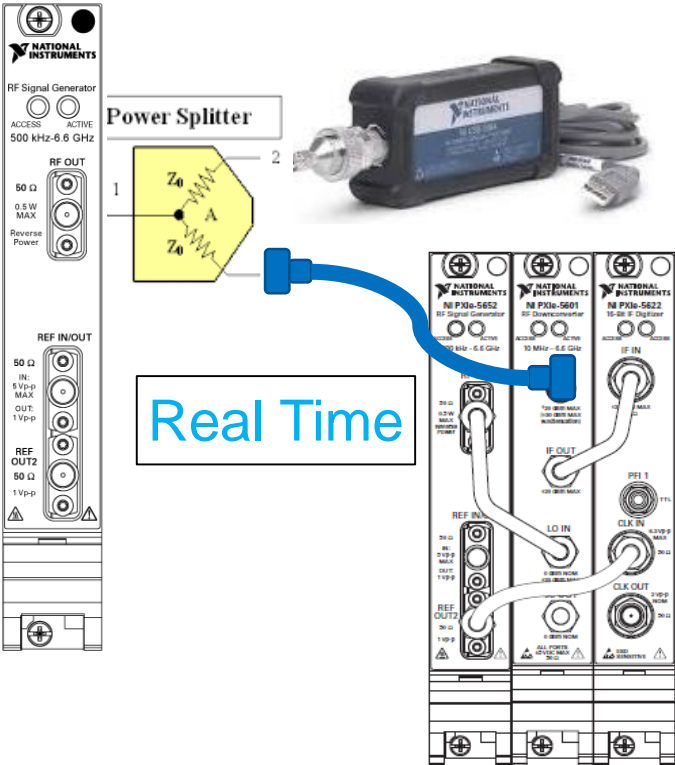
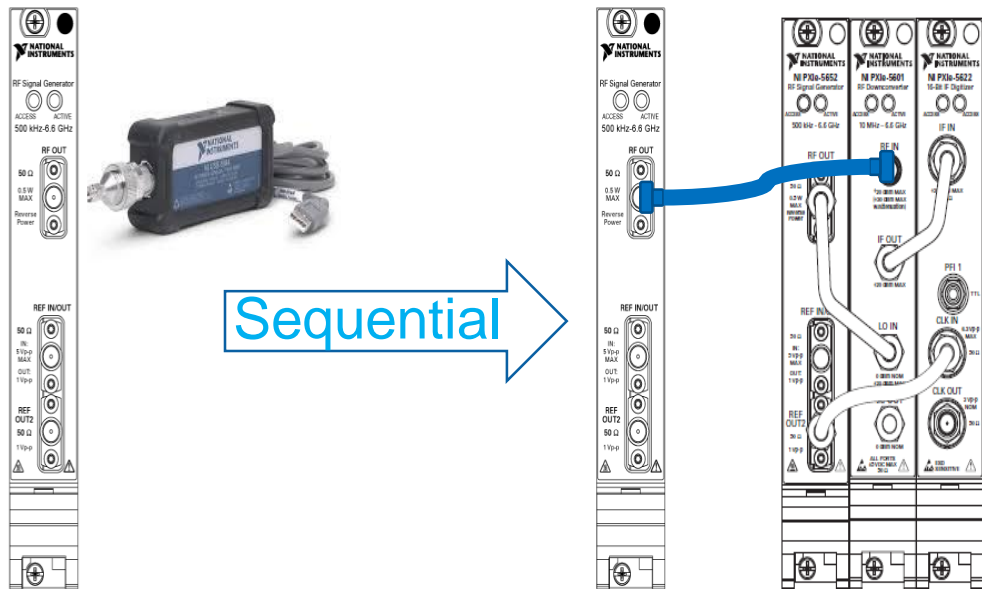

Measurement Uncertainty

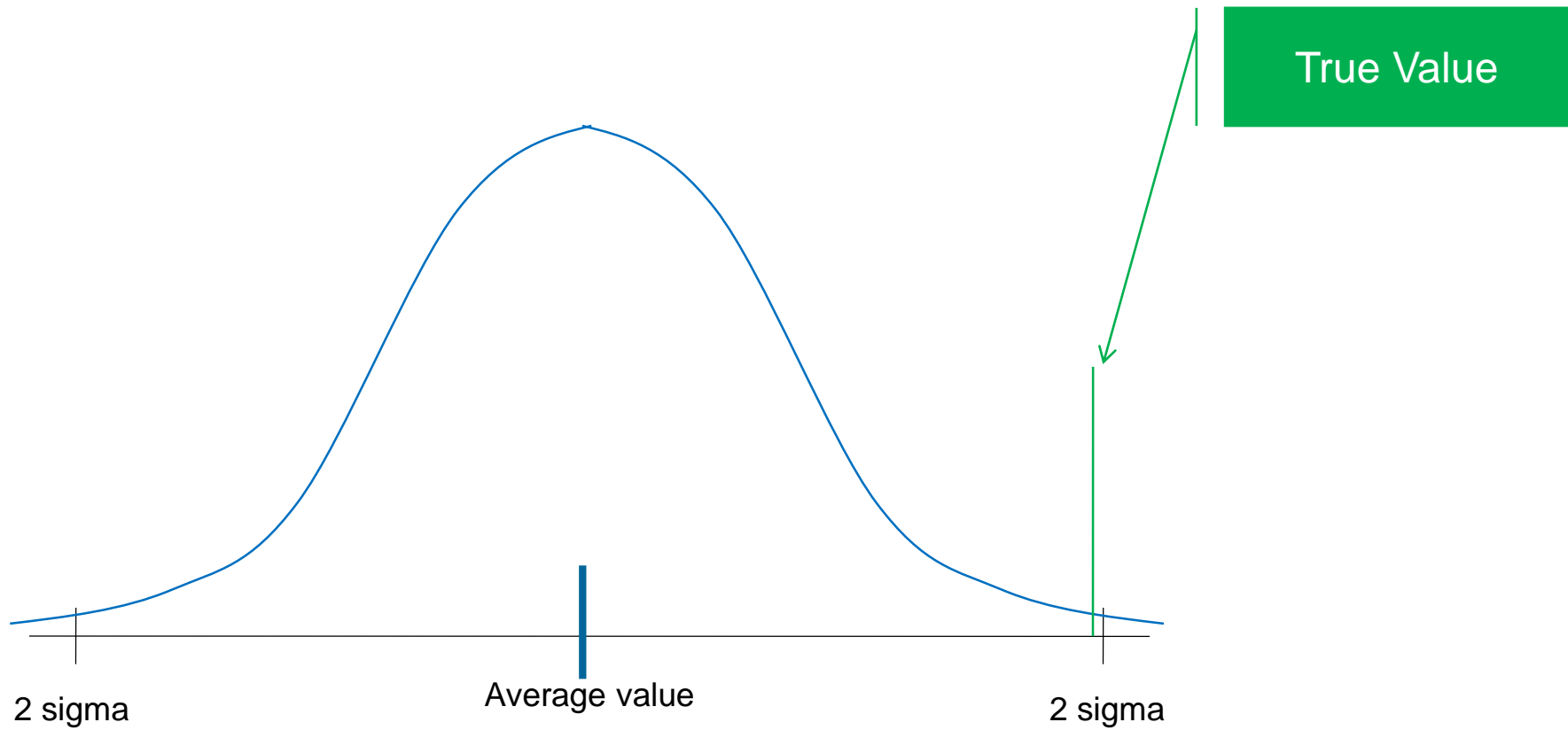

Most Common Uncertainty Components

- Standards specification
- Standards calibration uncertainty
- Standards Time stability
- Environmental conditions Common mode errors
- Instrument resolution
- Repeatability
- Retrace error
- SW errors (e.g. rounding)
- Equipment and connections layout
- Thermoelectric Voltages
- Loading and cable impedance
- Mismatch errors
- Directivity Test Port Match on VRC
- RF connector repeatability

Is Your Uncertainty Good Enough?

$$\text{TUR} = \frac{\text{Accuracy of Device Under Test}}{\text{Uncertainty of the measurement process}}$$

- Rule of thumb:
 - $\text{TUR} \geq 4:1 \Rightarrow$ We are done
 - $\text{TUR} < 4:1 \Rightarrow$ Review the characterization process

What If Your Uncertainty is Not Good Enough?

- Use a better characterization method
- Better characterization standards
- Eliminate the noise source
- Reduce standards uncertainty

Example Without Characterization

Stand Alone Source

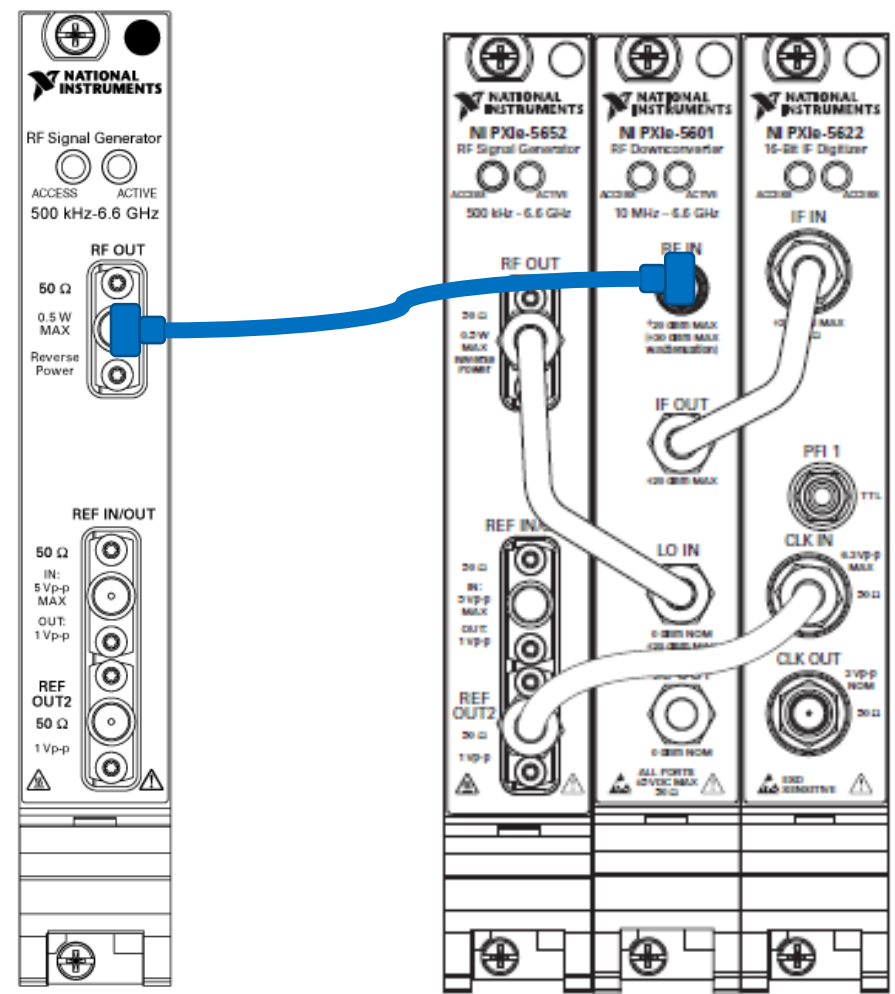

Calibrate DUT Amplitude accuracy at 0 dBm @ 4 GHz

Standard specifications		DUT
Amplitude accuracy	± 1.0 dB	± 1.6 dB
VSWR	1.8:1	2.0:1

Example Without Characterization Uncertainty Analysis (UA)

Stand Alone Source

Uncertainty component	Value	
Generator Amplitude Accuracy	$\pm 25.9\%$	$\approx \pm 1.0$ dB
Mismatch Generator-DUT	$\pm 19.0\%$	$\approx \pm 0.76$ dB
Measurement repeatability	$\pm 1.0\%$	$\approx \pm 0.09$ dB
Measurement uncertainty	$\pm 40\%$	$\approx +1.5$ dB ≈ -2.2 dB

DUT Accuracy $\pm 44.5\%$ (1.6 dB)

Measurement Uncertainty $\pm 40\%$

TUR= 1.1 << 4.0 Unacceptable

Example Characterization UA

Stand Alone Source + Power Sensor

First Step

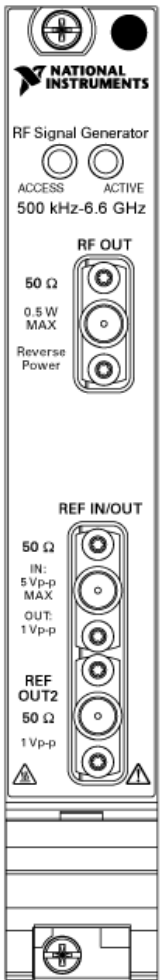

Characterize Generator Amplitude accuracy at 0 dBm @ 4 GHz		
Power Sensor specifications		Generator
Amplitude accuracy	± 0.13 dB	To be characterized
VSWR	1.22:1	2.0:1

Example Characterization UA

Stand alone source + power sensor

Uncertainty component	Value	
Power sensor absolute accuracy	$\pm 3.0\%$	$\approx \pm 0.13 \text{ dB}$
Mismatch Generator - Pw Sensor	$\pm 6.6\%$	$\approx \pm 0.28 \text{ dB}$
Measurement repeatability	$\pm 0.5\%$	$\approx \pm 0.04 \text{ dB}$
Characterization Measurement uncertainty	$\pm 10\%$	$\approx +0.4 \text{ dB}$ $\approx -0.5 \text{ dB}$

Save the Power Sensor average Measurements as the characterized output of the generator

For example = $+0.124 \text{ dBm} \pm 10\% @ 4 \text{ GHz}$

Example Characterization UA

Stand Alone Source + Power Sensor

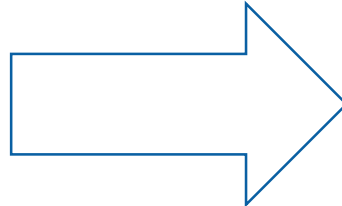

Second Step

Calibrate DUT with Characterized Source

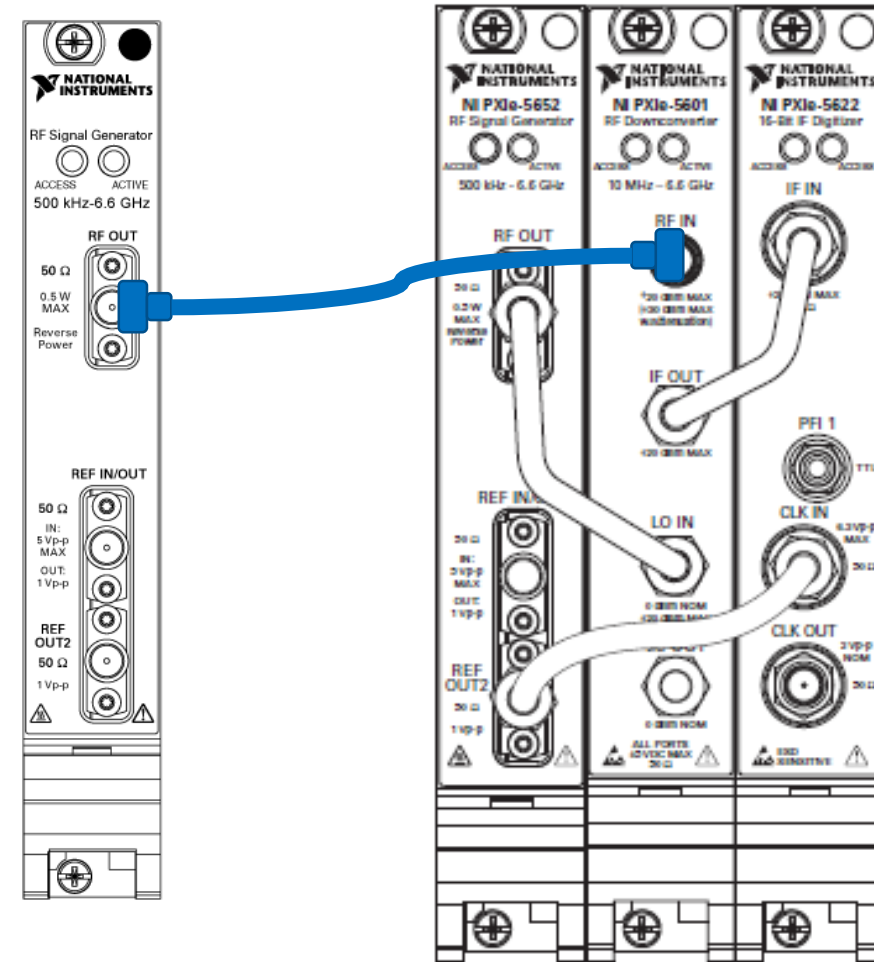

Example With Characterization UA

Stand Alone Source + Power Sensor

Uncertainty component	Value	
Characterization uncertainty	$\pm 10\%$	
Mismatch Generator-DUT	$\pm 6.6\%$	$\approx \pm 0.28$ dB
Generator retrace error	$\pm 5.0\%$	$\approx \pm 0.20$ dB
Measurement repeatability	$\pm 0.5\%$	$\approx \pm 0.04$ dB
Measurement uncertainty	$\pm 14.9\%$	$\approx +0.6$ dB ≈ -0.7 dB

Characterized output of the generator [0 dBm] = **+0.124 dBm $\pm 15\%$ @ 4 GHz**

DUT Accuracy $\pm 44.54\%$ (1.6 dB)

Measurement Uncertainty $\pm 14.9\%$

TUR= 3.0 << 4.0 Unacceptable but better

Example Characterization UA

Stand Alone Source + Power Sensor + Power Splitter

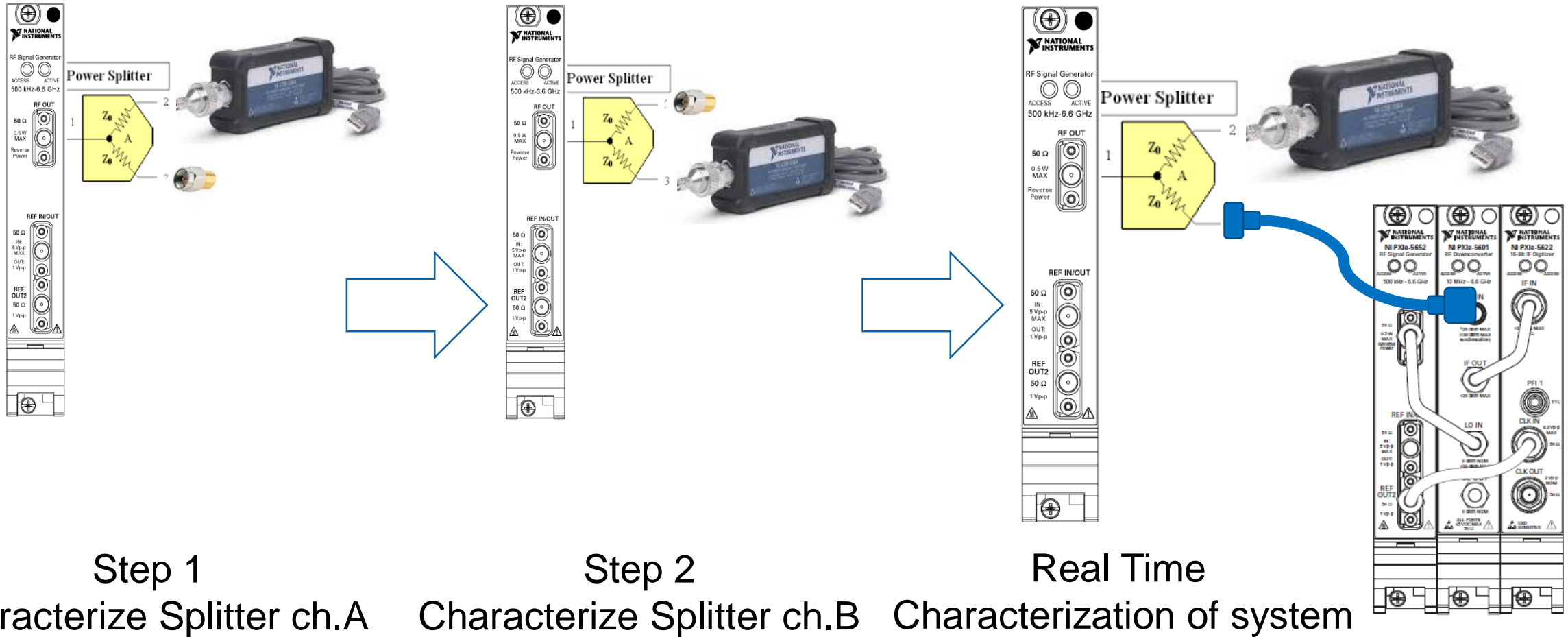

Example Characterization UA

Stand Alone Source + Power Sensor + Power Splitter

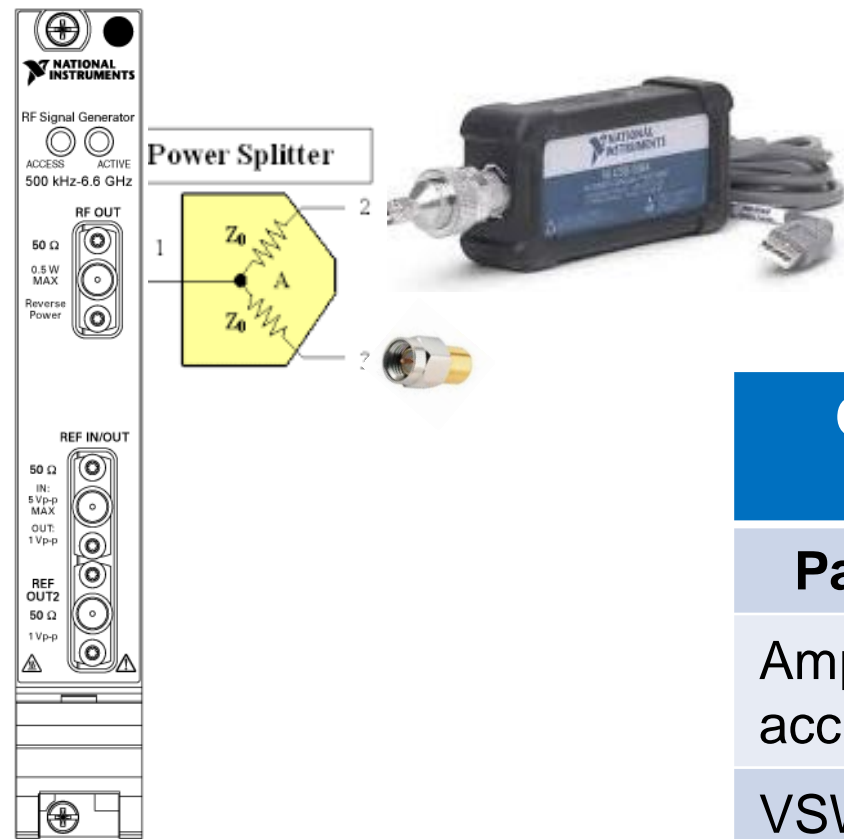

Step 1

Characterize Generator/Splitter Ch. A Amplitude accuracy at 0 dBm @ 4 GHz			
Parameter	Power Splitter	Power Sensor	Generator
Amplitude accuracy	To be characterized	± 0.13 dB	NA
VSWR	1.22:1	1.22:1	NA

Example With Characterization UA

Stand Alone Source + Power Sensor + Power Splitter

Step 1

Uncertainty component	Value	
Power sensor absolute accuracy	$\pm 3.0\%$	$\approx \pm 0.13 \text{ dB}$
Mismatch Splitter-Pw Sensor	$\pm 2.0\%$	$\approx \pm 0.08 \text{ dB}$
Measurement repeatability	$\pm 0.5\%$	$\approx \pm 0.04 \text{ dB}$
Characterization Measurement Uncertainty =	$\pm 4.6\%$	$\approx +0.2 \text{ dB}$ $\approx -0.2 \text{ dB}$

Save the Power Sensor average Measurements as the characterized output Splitter ch.A

For example = $+0.002 \text{ dBm} \pm 4.6\% @ 4 \text{ GHz}$

Example Characterization UA

Stand alone source + power sensor + power splitter

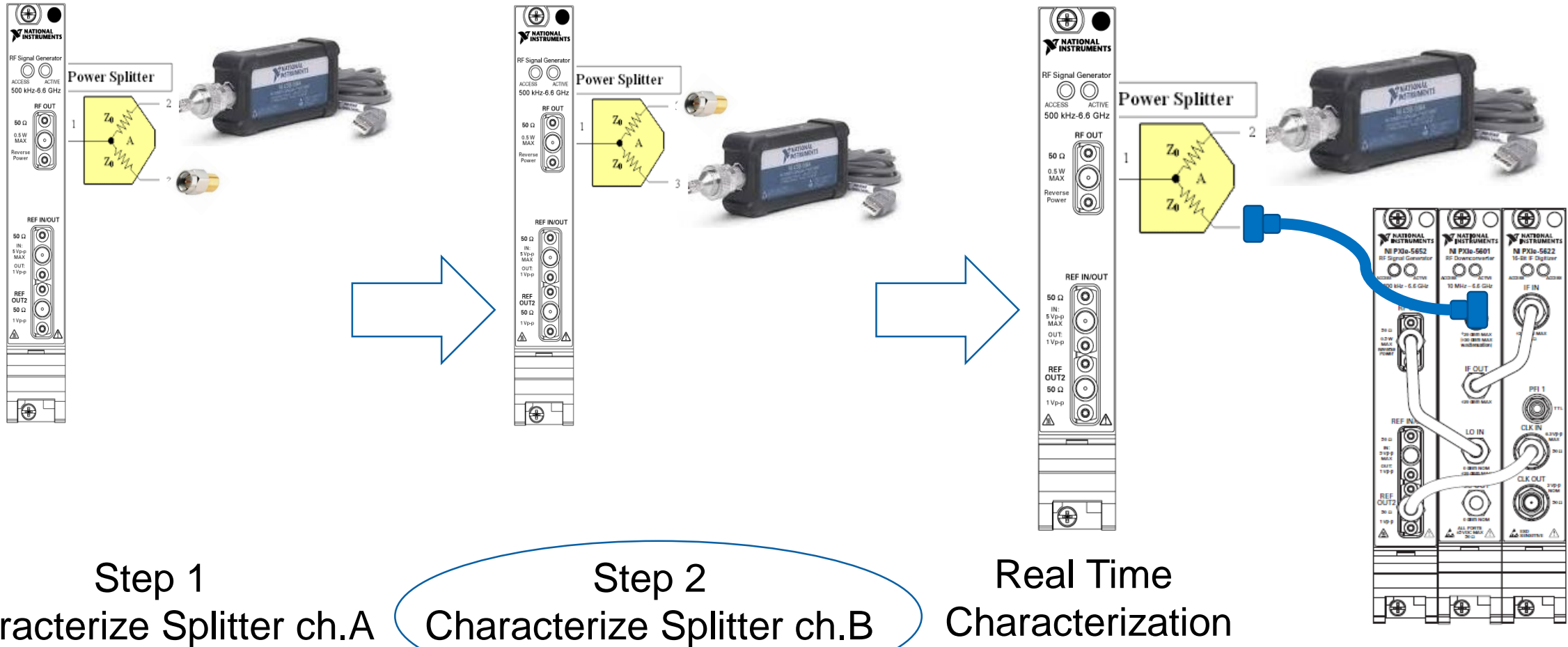

Example With Characterization UA

Stand Alone Source + Power Sensor + Power Splitter

Step 2

Uncertainty component	Value	
Power sensor absolute accuracy	$\pm 3.0\%$	$\approx \pm 0.13 \text{ dB}$
Mismatch Splitter-Pw Sensor	$\pm 2.0\%$	$\approx \pm 0.08 \text{ dB}$
Measurement repeatability	$\pm 0.5\%$	$\approx \pm 0.04 \text{ dB}$
Characterization Measurement Uncertainty =	$\pm 4.6\%$	$\approx +0.2 \text{ dB}$ $\approx -0.2 \text{ dB}$

**Save the Power Sensor average Measurements as the
characterized output Splitter ch.B**

For example = $+0.009 \text{ dBm} \pm 4.6\%$ @ 4 GHz

Example Characterization UA

Stand Alone Source + Power Sensor + Power Splitter

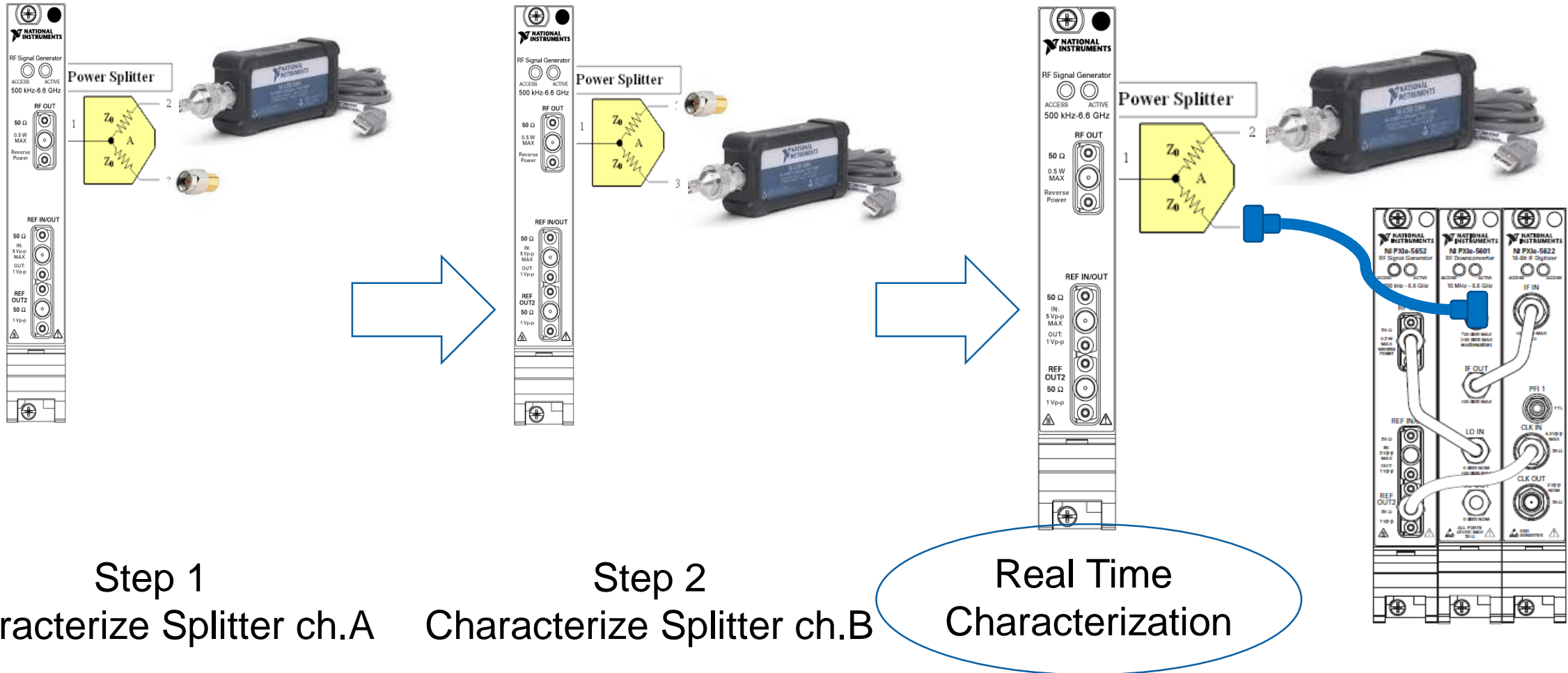

Example With Characterization UA

Stand Alone Source + Power Sensor + Splitter

Step 3

Uncertainty component	Value	
Power sensor absolute accuracy	$\pm 3.0\%$	$\approx \pm 0.13$ dB
Uncertainty characterization step 1	$\pm 4.6\%$	$\approx \pm 0.13$ dB
Uncertainty characterization step 2	$\pm 4.6\%$	$\approx \pm 0.13$ dB
Mismatch Splitter-DUT	$\pm 6.6\%$	$\approx \pm 0.28$ dB
Measurement repeatability	$\pm 0.5\%$	$\approx \pm 0.04$ dB
Total Characterization Measurement Uncertainty =	$\pm 11.8\%$	$\approx +0.48$ dB ≈ -0.55 dB

DUT Accuracy $\pm 44.54\%$ (1.6 dB)

Measurement Uncertainty $\pm 11.8\%$

TUR= 3.8 \approx 4.0 Practically Acceptable

Example Characterization UA

Stand Alone Source + Power Sensor + power Splitter + Attenuator

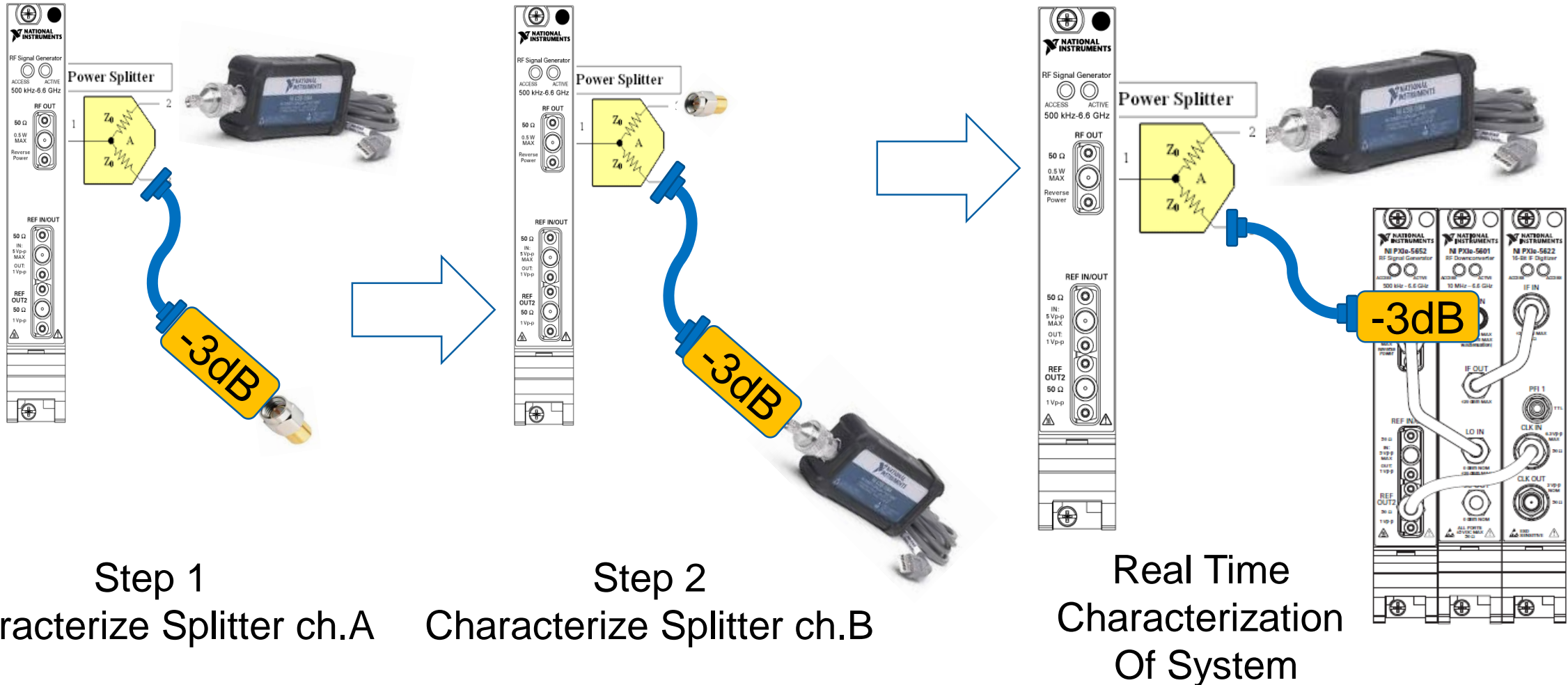

Example With Characterization UA

Uncertainty component	Value	
Power sensor absolute accuracy	$\pm 3.0\%$	$\approx \pm 0.13$ dB
Uncertainty characterization step 1	$\pm 4.6\%$	$\approx \pm 0.13$ dB
Uncertainty characterization step 2	$\pm 4.6\%$	$\approx \pm 0.13$ dB
Mismatch Splitter-DUT	$\pm 3.2\%$	$\approx \pm 0.14$ dB
Measurement repeatability	$\pm 0.5\%$	$\approx \pm 0.04$ dB
Total Characterization Measurement Uncertainty =	$\pm 8.6\%$	$\approx +0.33$ dB ≈ -0.36 dB

DUT Accuracy $\pm 44.54\%$ (1.6 dB)

Measurement Uncertainty $\pm 8.6\%$

TUR = 5.1 > 4.0 Acceptable

Characterization Summary

Characterization method	Uncertainty	Improvement
No characterization – Generator direct	$\pm 40\%$	Reference
Pre-Characterization – one step	$\pm 15\%$	2.6x better
Real time output characterization – 3 step	$\pm 11.8\%$	3.5x better
Real time output characterization – 3 step with attenuator	$\pm 8.6\%$	4.7x better

System Characterization Frequency

- If no historical data – Characterize before use
- Save characterization data
- Performance is **system** and **method** specific



Characterization – Other Benefits

- Characterized devices do not need to be calibrated or directly traceable to SI units
- Only the standards used in the characterization need calibration and traceability to SI units
- Less station down time and less maintenance costs
 - Only standards require external calibration
 - One set of standards can characterize multiple stations
- Trend data available for analysis to determine:
 - Characterization interval of the calibration system
 - Early detection of equipment malfunction
 - Excessive system drift and noise

Characterize System Accuracy

System Characterization Plane

System

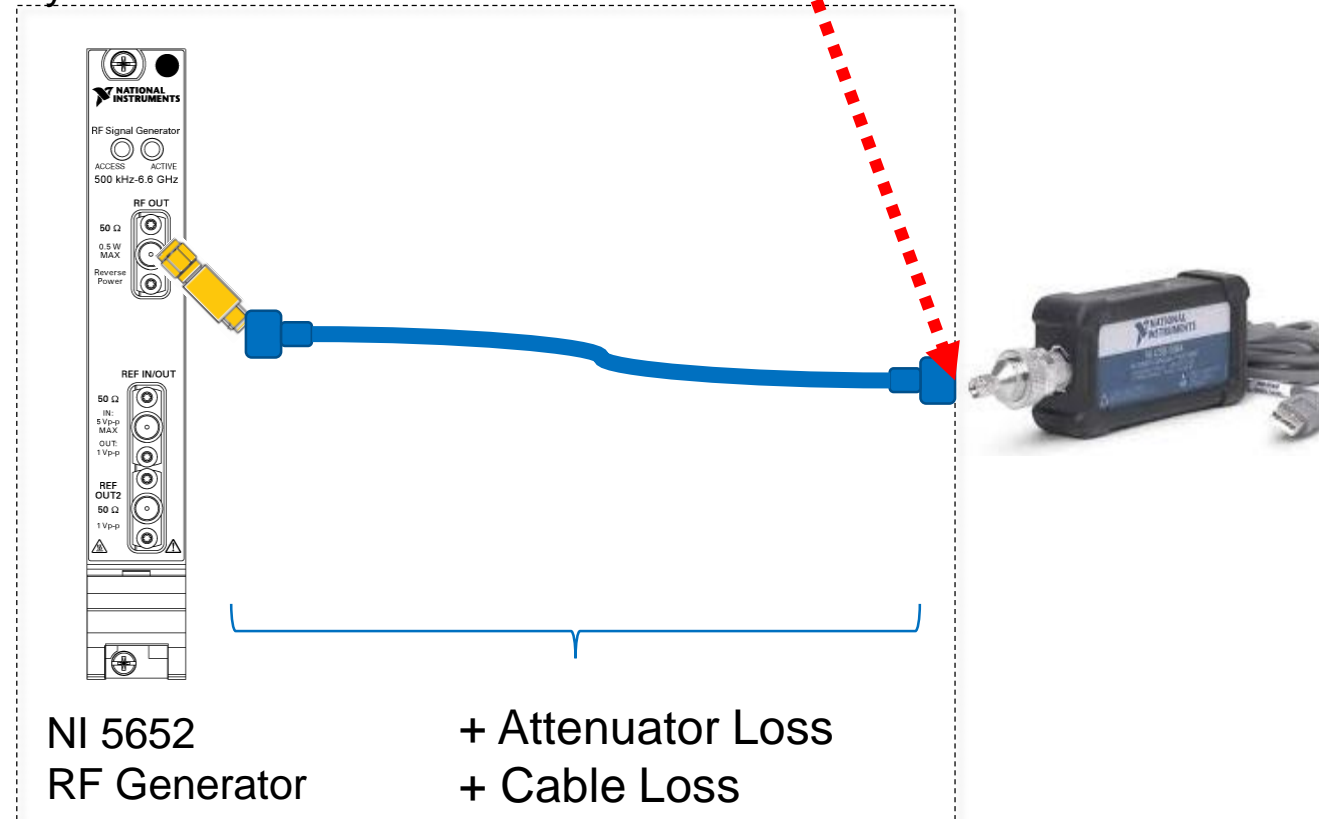

General Purpose vs. Specific Application

- Specific Applications
 - Discrete set of modes and ranges
- General Purpose Applications
 - Wide range or unbounded/continuous sets of modes and ranges

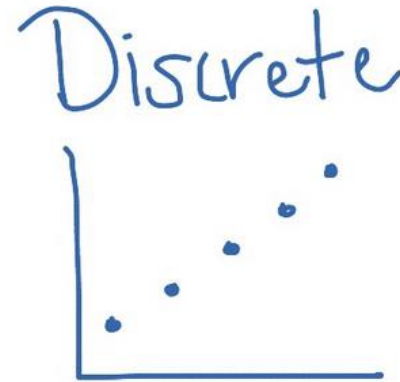

General Purpose Application Challenges

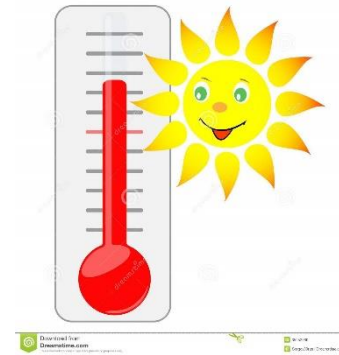
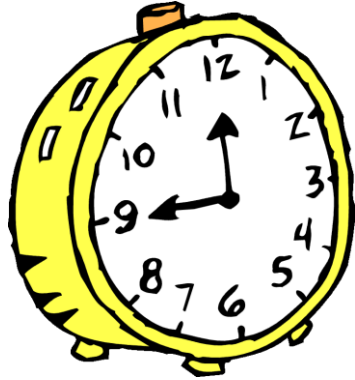

Continuous Range (32-bit integer = 4.2 billion points)

Characterization Interpolation

- Limited data points... requires **Interpolation** between readings
- Primary source of interpolation error is due to linearity

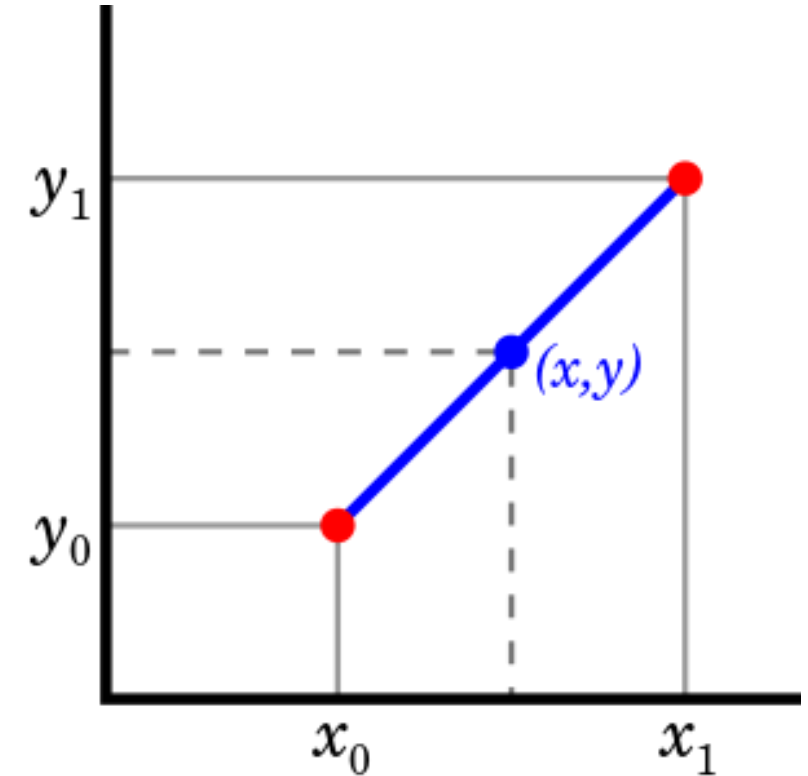

Building a Table of Corrections

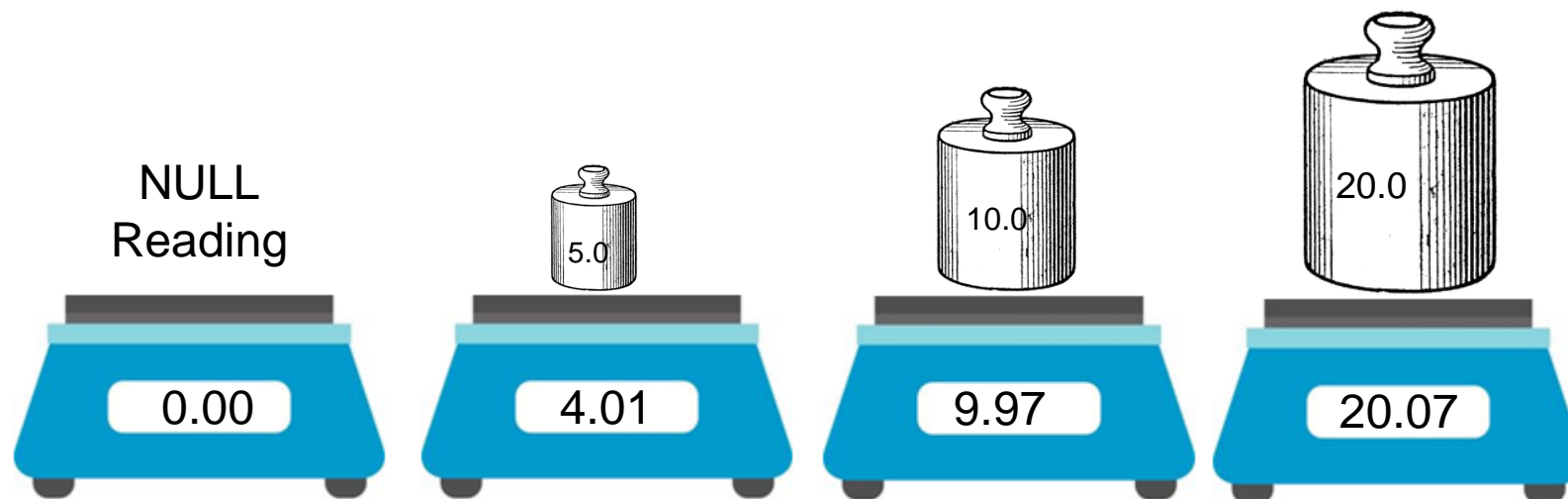
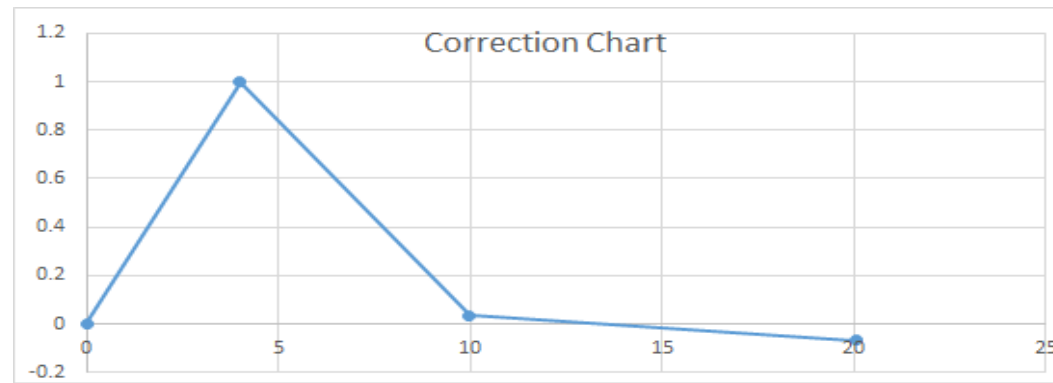

Using a Correction Table

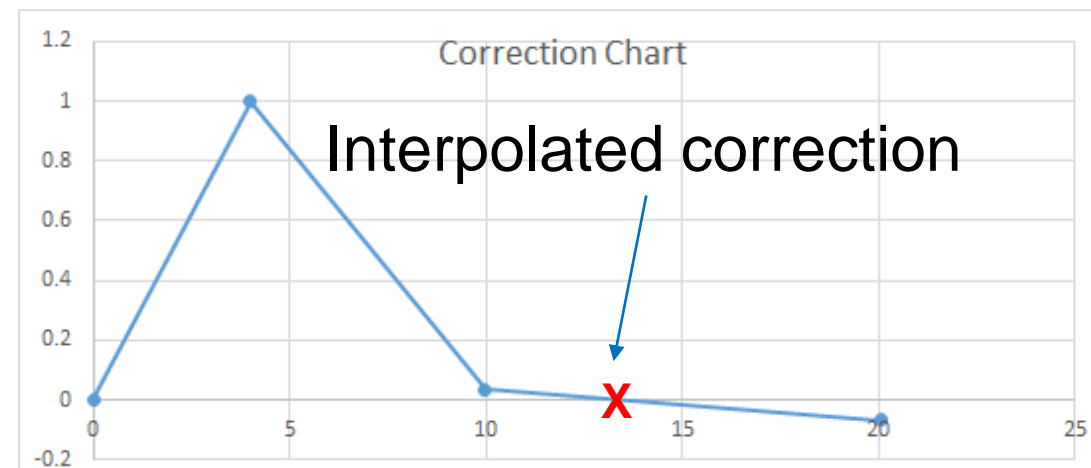
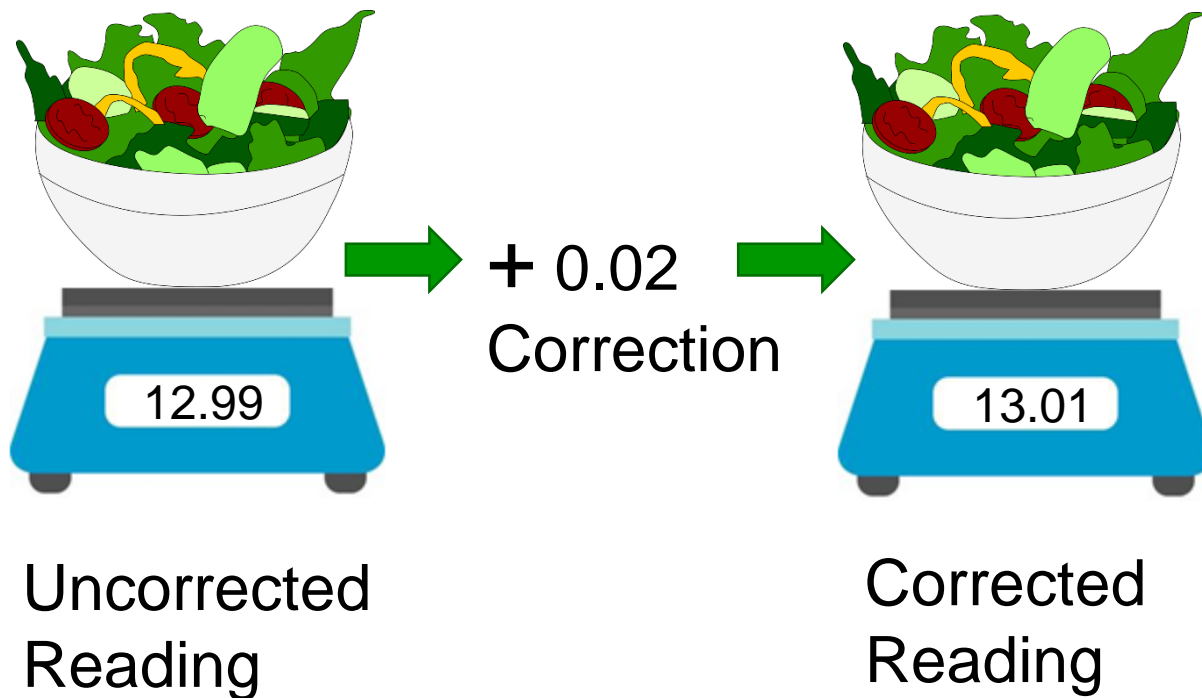

Increase the Number of Points

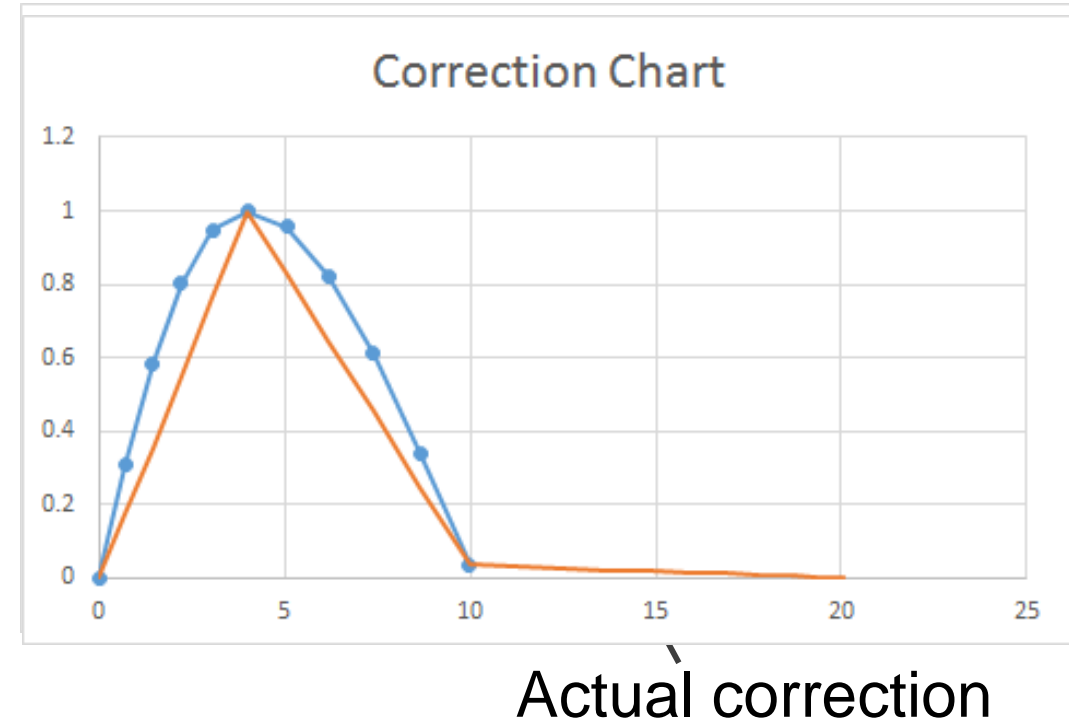
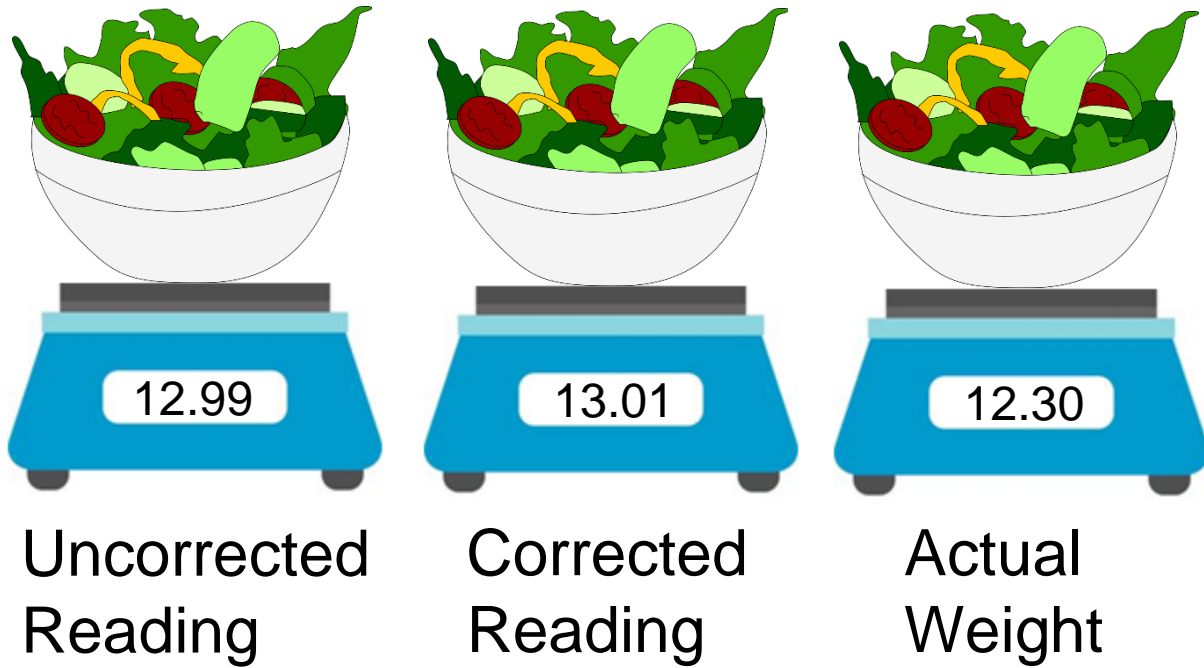

Applying Characterization Data

Post-Process results

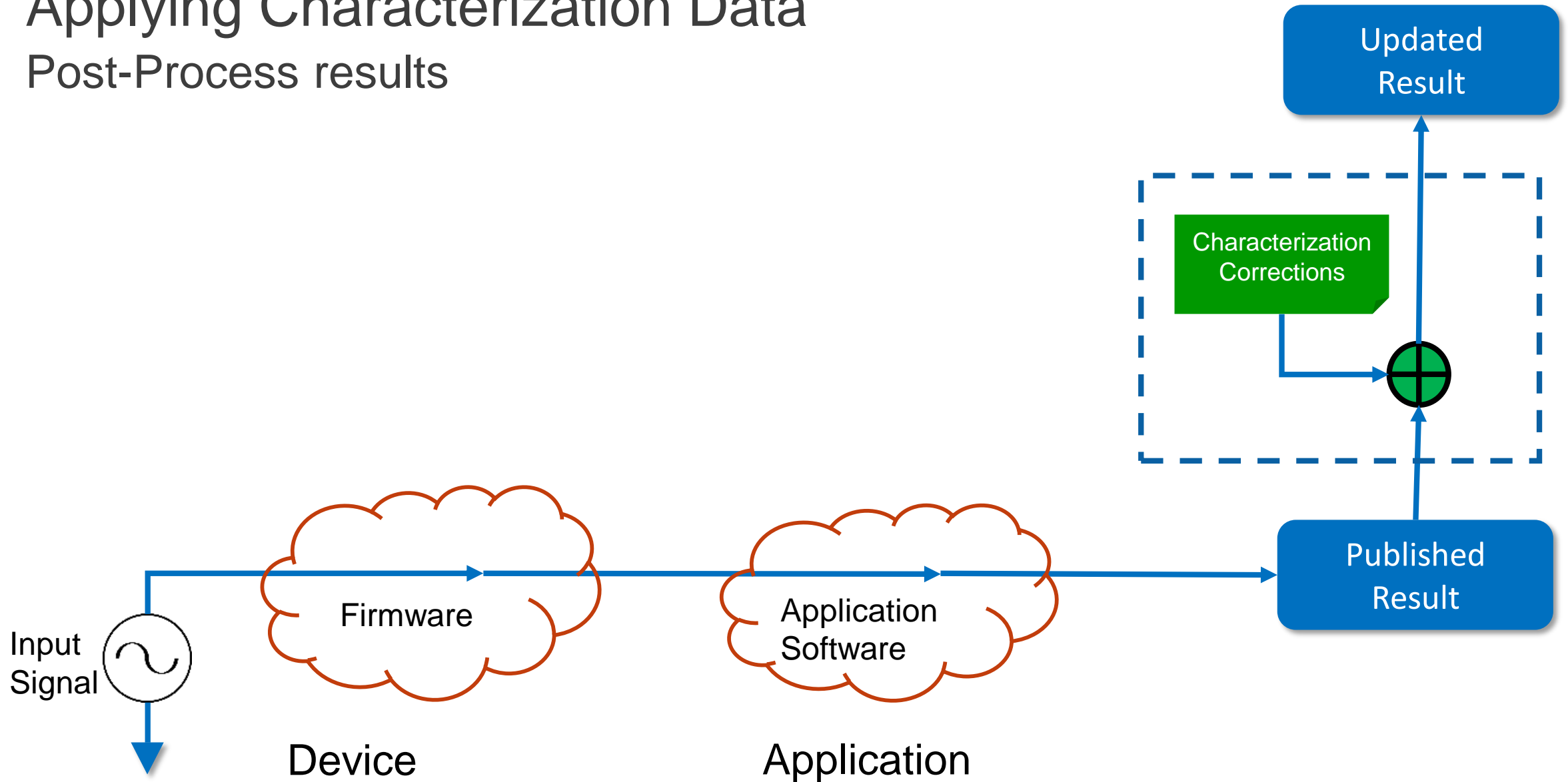

Applying Characterization Data

Process characterization inside the application

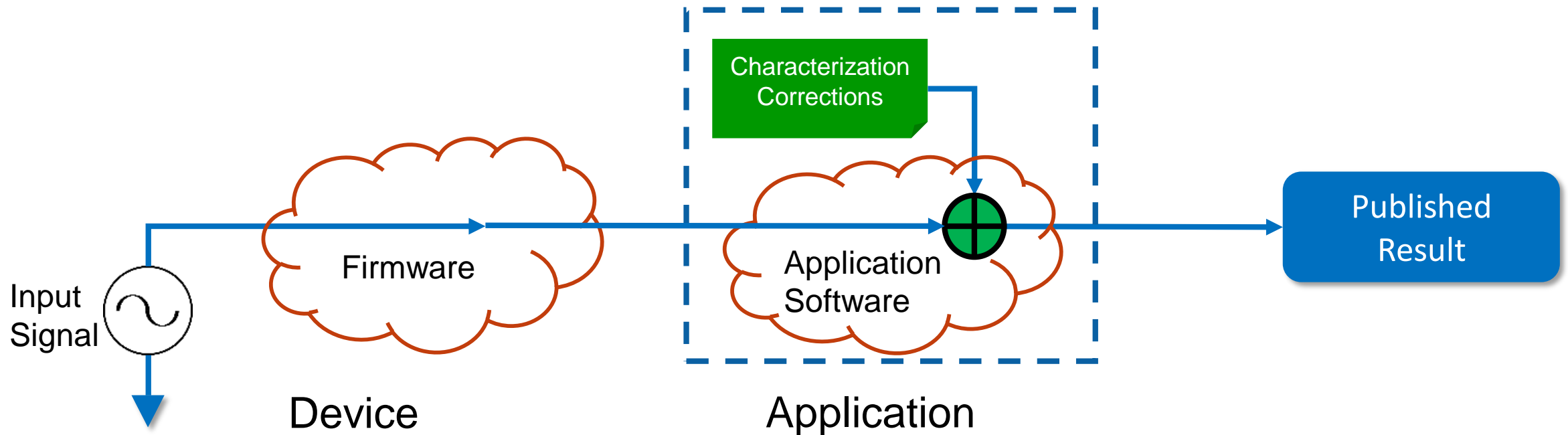

Applying Characterization Data

Process characterization inside device firmware

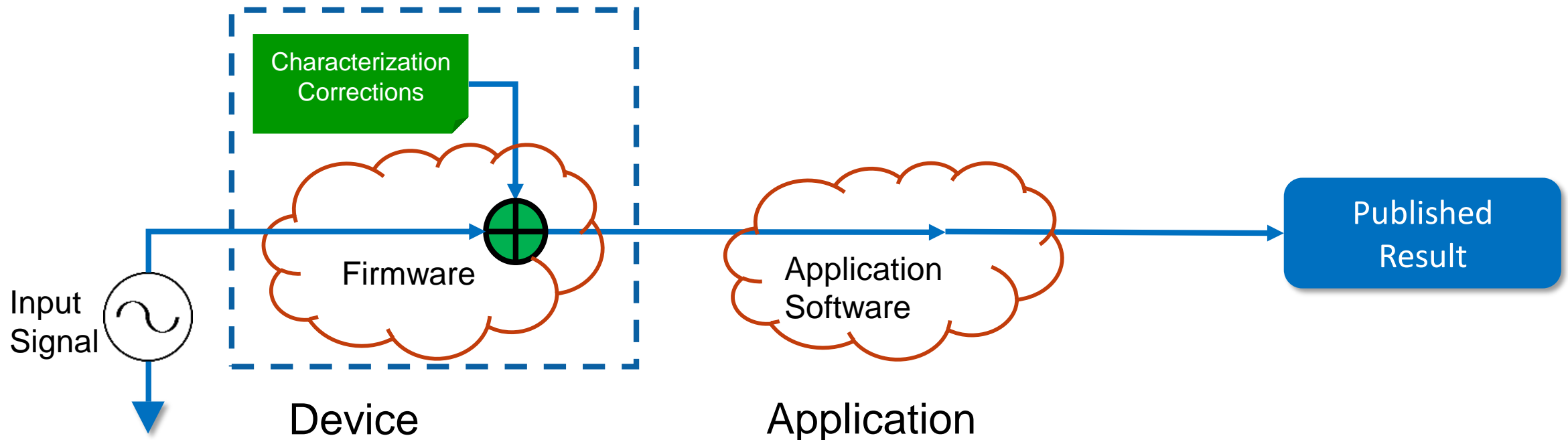

Characterization Storage Options

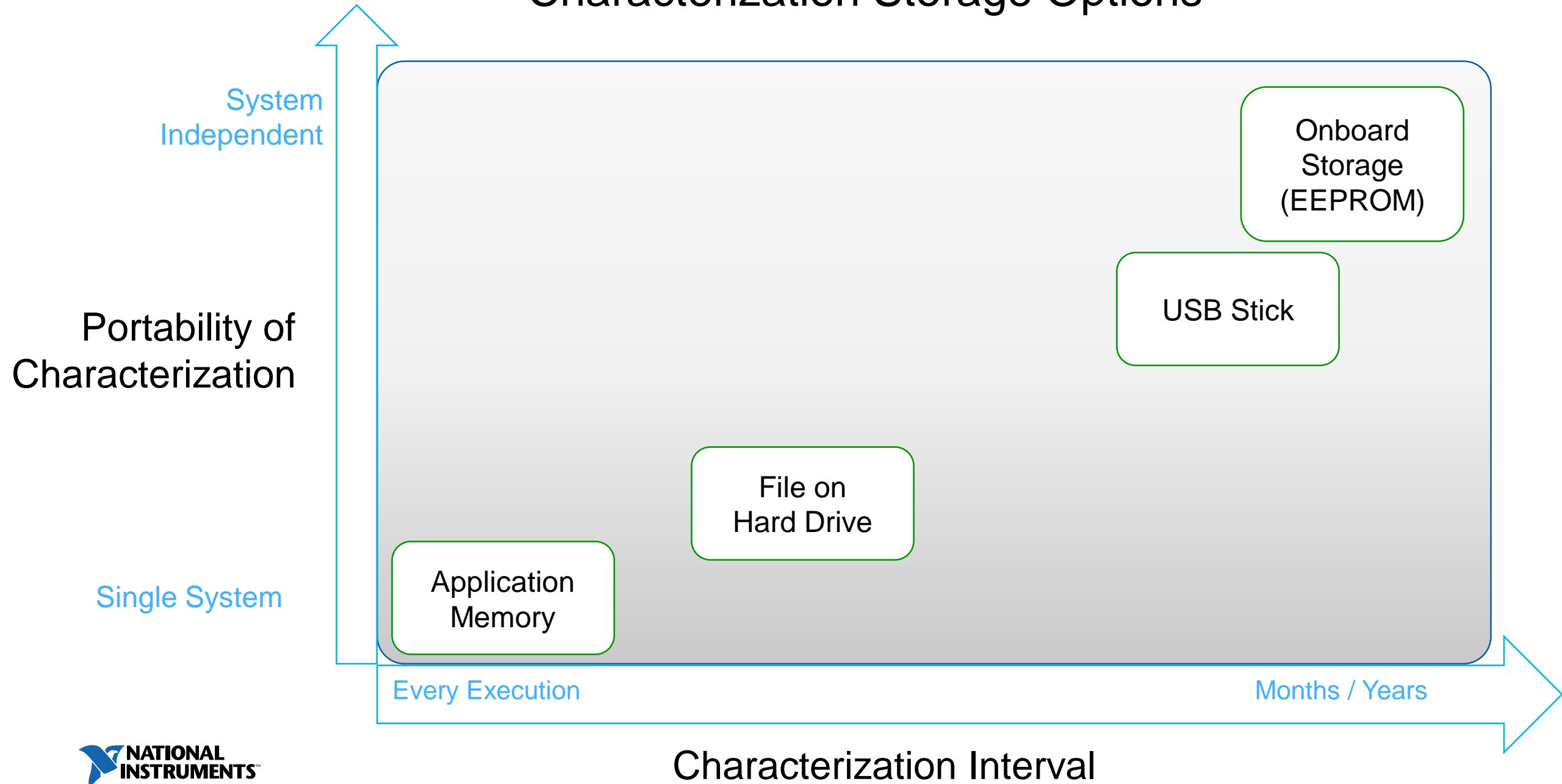

Stay Connected During and After NIDays



ni.com/niweekcommunity



facebook.com/NationalInstruments



twitter.com/niglobal



youtube.com/nationalinstruments

